

LEADERS INFORMATION PACKET



JANUARY 19-21, 2001

at

Old Pinehurst Ski Hill

Eau Claire

For more in Information or Questions

Contact: Glenn Swanson

715-832-3621

ildfree@execpc.com

REGISTRATION TIMES:

Friday night 7:00 PM – 8:00 PM

Saturday 7:30 AM – 8:30 AM

FRIDAY NIGHT SCHEDULE:

Campfire

Skating

Hot Chocolate

Star Hike

SATURDAY SCHEDULE:

Event stations start at 8:30 AM SHARP!!

Lunch served at 12:30 - Magic Stew

Exhibitors Display open till 3:00 PM

Misc. Demonstrations

Snowshoe broomball

Dutch-oven Dessert Cook-off

Campfire with skits and guest speaker

SITE LOCATION:

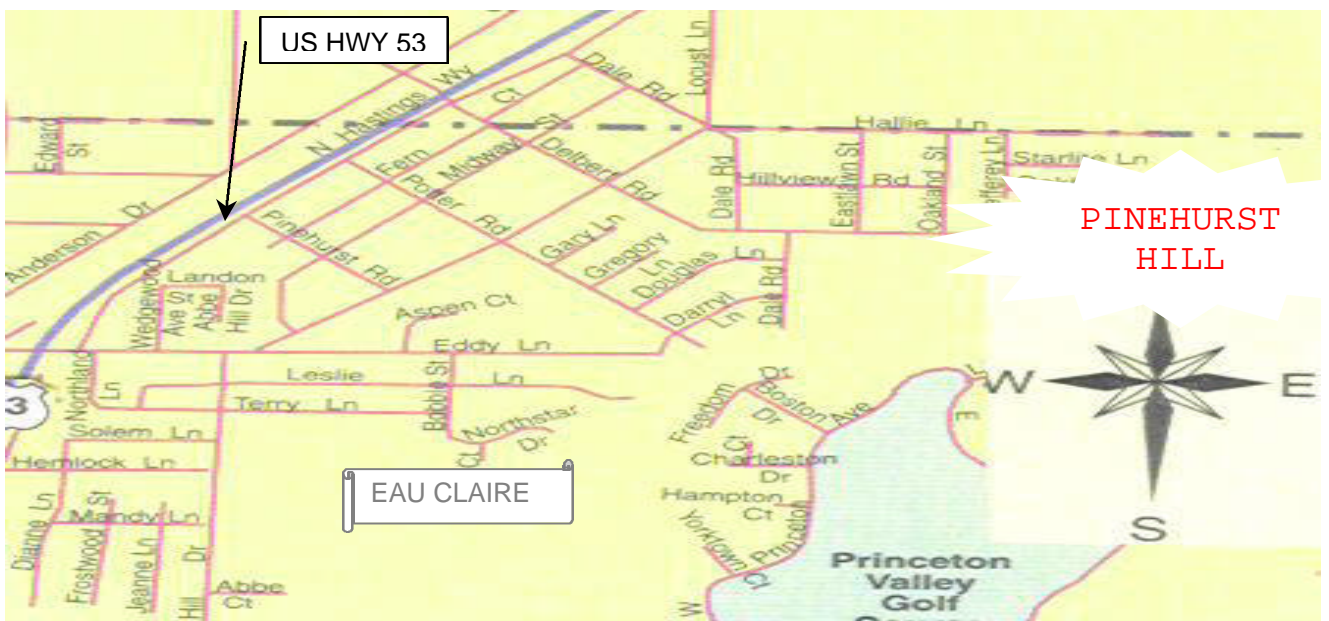

STATION EVENTS:

Station #1	Exhibitors Display
Station #2	First Aid
Station #3	Compass Course
Station #4	Snow Ball Throw
Station #5	Fire Building
Station #6	Norwegian Skiing
Station #7	Slingshot Pie Pan Shooting
Station #8	Wrist Rockets
Station #9	to be determined

STATIONS start on the half hour, points will be deducted if late.
Compete in the stations you want or do them all.

LUNCH Served at 12:30 by the campfire – Magic Stew
Everyone must bring a can of soup (the can will be their bowl)

THE SLED RACE starts after the stations close at 3 PM.
Scoutmaster or Assistant Scoutmaster must ride on the sled
Webelos must choose a person to ride their sled

DINNER & BREAKFAST are the troops responsibility.

DUTCH-OVEN DESSERT COOK-OFF will be held at
campfire prior to the Campfire Programs. The dessert has to be made for every 8 people
in your troop; i.e., 9 people means
2 desserts!

CAMPFIRE PROGRAMS will have only 5 skits presents along
With a special guest speaker to wrap-up the evening

EQUIPMENT LIST:

Patrols must have these with them on their sled:

- First Aid Kit - Blanket - Compass
- Pocket Knife - Matches in a Waterproof Container
- One-gallon jug of water and a container to fix
Hot chocolate in, over an open fire
- Empty soup can per person
- One extra pair of socks per person
- One candy bar per person
- Sled full of enthusiasm!!

Dress for the weather NO tennis shoes
Everyone must have winter boots on!!

REGISTRATION DEADLINE date is January 16, 2001. Walk-ins
will be charged \$8.00 per person, so please plan ahead
Mail the registration form and your money to:

Chippewa Valley Council
710 S. Hastings Way
Eau Claire, WI 54701

REGISTRATION FORM

Pack/Troop/Crew/Post number: _____

Contact person: _____

Telephone number: _____

Number of participants: _____ @ \$5.00/person Total payment
\$_____.00

Arrival Time: Friday _____ Saturday _____

REG. DEADLINE date is January 16, 2001 Mail to: CVC 710 S. Hastings Way, Eau Claire, WI 54701

